

# PRODUCT SHEET



Protection security shutters make it possible to secure information in a medical office environment without having to relocate the existing medical records. Unlike most retrofit solutions available on the market today, the design of a rolling security door provides a solution that results in minimal to no loss of filing space. Each rolling door unit is designed for easy installation resulting in minimal down time for clients.

The manufacturing design of the pre-assembled box incorporates a counter-balance spring to facilitate easy lifting, and provides a check against rapid closing speeds. This counter balance design incorporates metal slats that consist of two aluminum skins sandwiched with a core of polyurethane foam thus providing lightweight strength.

To eliminate unwanted resistance or misalignment that is found with other products, the alignment is accomplished by the installation of the pre-assembled box into the guide rails, thus ensuring a smooth transition of the slats from the box to the rail system. After each of the two guide rails are inserted into the pre-assembled box, the assembled unit is then attached to the existing cabinetry.

The physical components consist of the side guide rails and a pre-assembled box, which houses the roll of slats. When the side guide rails are less than 76", the box will be 6½" X 6½" square. Longer guide rails will require a 7" X 7" box. Side guide rails measure 2 1/8" wide X 7/8". Drilling for guide rails can be surface drilling, on the 2 1/8" face, or recess drilling, on the 7/8" side.

Locking is provided by a single key cylinder lock that is located in the middle of the base slat. The rotation of the key cylinder forces the internal locking bars to be pushed into the side guide rails.

## Features

- Easy to install, affixing to existing cabinetry
- Installation involves minimal down time
- Existing charts do not need to be relocated
- Loss of filing space - minimal to none
- Spring-Assisted for effortless operation
- Counter-balance controls movement
- Entire panel locks with a single key
- Widths up to 12 feet in a single panel
- Multi-panel designs are possible for applications wider than 12 feet

## Mechanical Parts

- 1 Assist Spring
- 2 Center Axle
- 3 Insert Bearing
- 4 Housing Box – Back
- 5 Housing Box – Front
- 6 Retainer Plates
- 7 Entry Guide
- 8 End Cap
- 9 Guide Rails
- 10 Bottom Slat

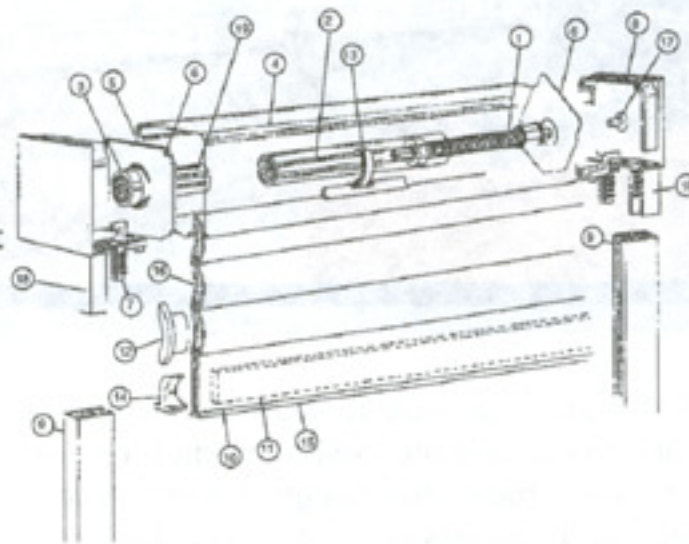

- 11 Steel Weight
- 12 Side Lock
- 13 Hanging Straps
- 14 Impact Stop
- 15 Cushioned Insert
- 16 Slat
- 17 End Cap Pivot Post
- 18 End Cap Ear
- 19 Axle Insert

## Measuring Guide

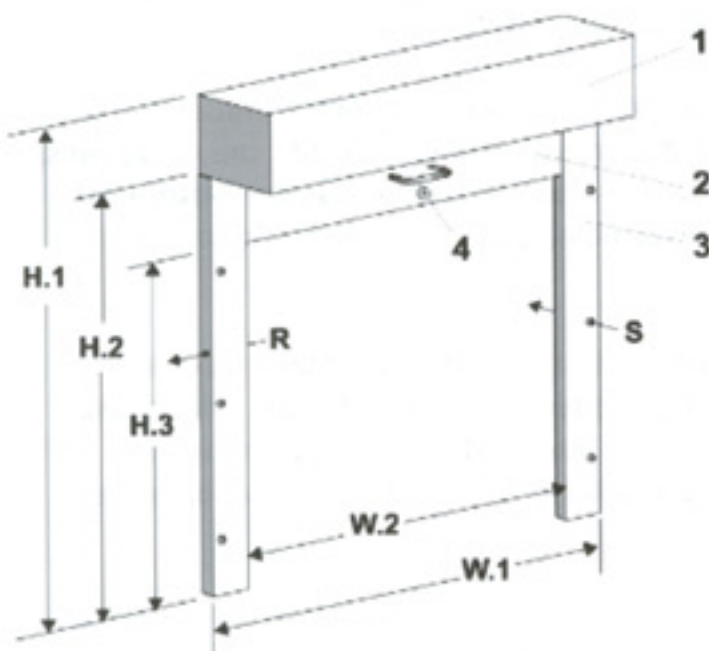

Refer to this diagram for height and width measurements and drilling options.

- |     |   |                       |
|-----|---|-----------------------|
| 1   | - | Housing               |
| 2   | - | Bottom Slat           |
| 3   | - | Guide Rail            |
| 4   | - | Key Cylinder Lock     |
| R   | - | Recess Drilling       |
| S   | - | Surface Drilling      |
| H.1 | - | Overall Height        |
| H.2 | - | Guide Rail Height     |
| H.3 | - | Height to Bottom Slat |
| W.1 | - | Overall Width         |
| W.2 | - | Surface Width         |



# FILE EXTENDERS

With **file extenders** from Protection Security Shutters, existing shelving can be easily modified for a hassle-free retrofit. Because many existing folders extend out and in front of the shelving, **file extenders** provide the additional space needed for our rolling doors to clear protruding files.

The below shelving modification provides up to 2 inches of full depth extension in front shelving.

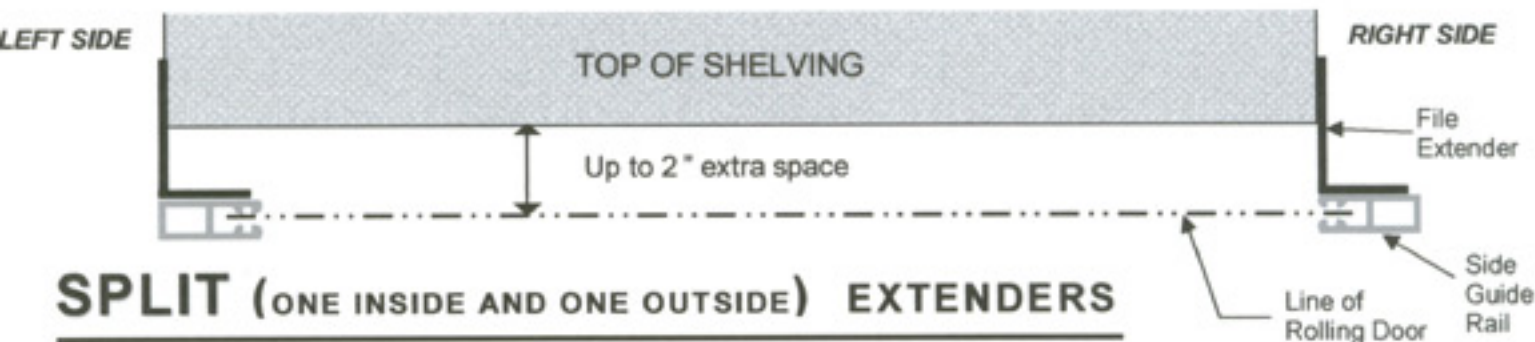
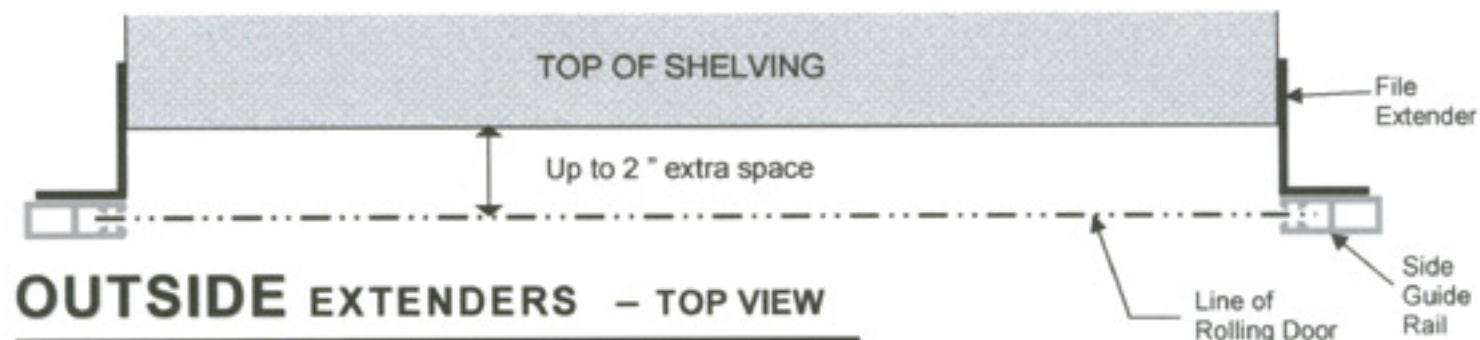
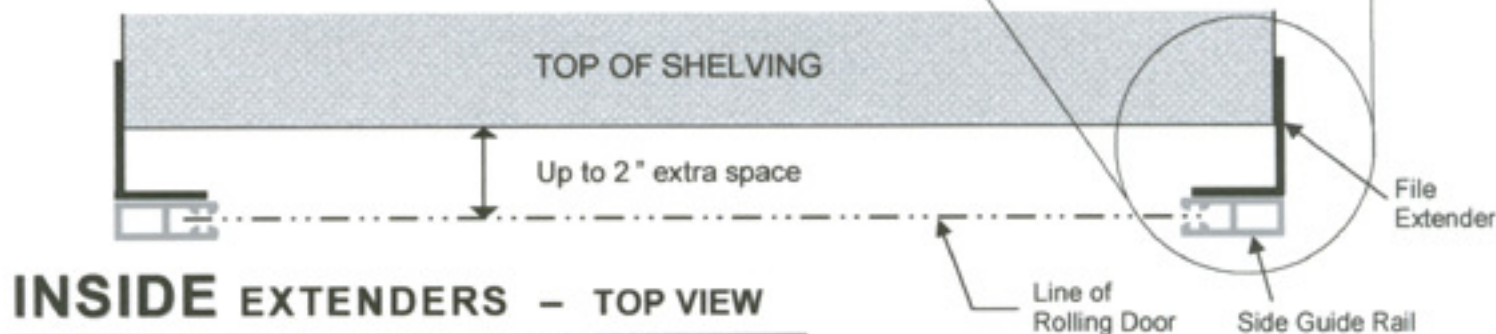
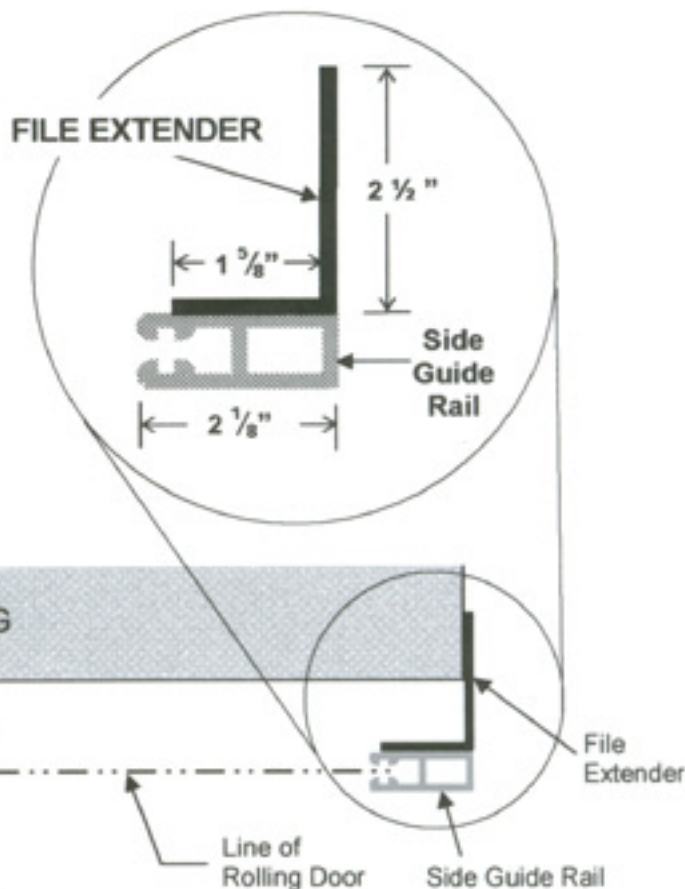

\*Split Extenders include any combination of one *inside* extender and one *outside* extender.